

NOTES:

1. RECOMMENDED MINIMUM 18" CLEARANCE ALL AROUND SPA, UNLESS OTHERWISE SPECIFIED.
2. (2) SYMBOL SHOWS 8 OPTIONAL INTERIOR PERIMETER LIGHT LOCATIONS.
3. IF EQUIPPED, OZONATOR IS LOCATED BEHIND PANEL ON THE PUMP/PACK SIDE.
4. DRAIN VALVE LOCATED BEHIND PANEL ON THE PUMP/PACK SIDE
5. SEE OWNERS MANUAL FOR COMPLETE LOCATING , ELECTRICAL AND SAFETY INSTRUCTIONS.
6. LOAD: 160 PSF

*COVER LIFTER AND STEP ARE PART OF SUITE PACKAGE.

RECOMMENDED ELECTRICAL PASS-THROUGH AREA FOR PERMANENT WIRING OF CS2-PU2 OR CONVERTED CS2-PU1. SEE ROUTING & ELECTRICAL SUGGESTIONS.

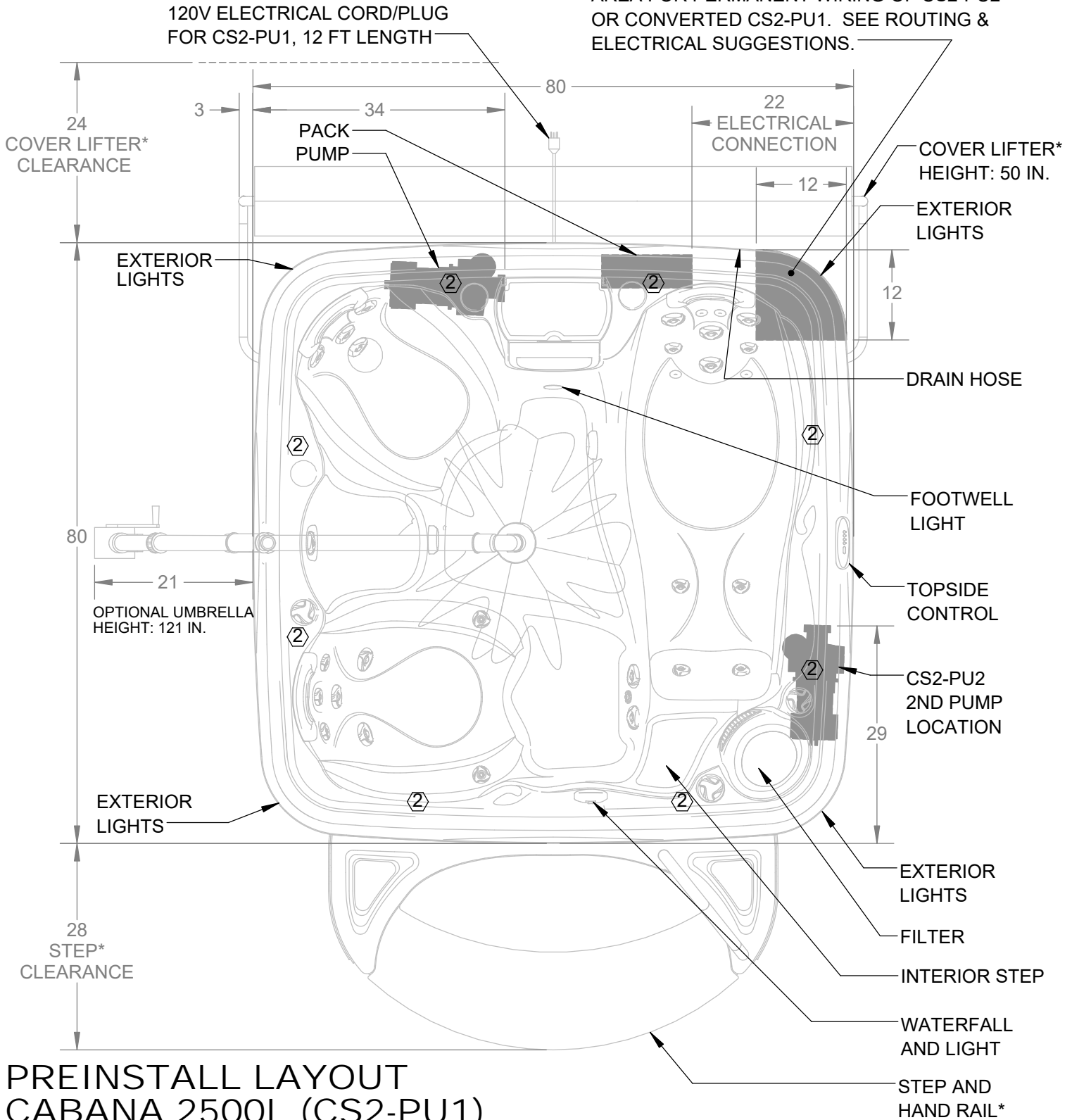

**PREINSTALL LAYOUT
CABANA 2500L (CS2-PU1)
CABANA 3500L (CS2-PU2)
SUITE PACKAGE**

NOTES:

1. RECOMMENDED MINIMUM 18" CLEARANCE ALL AROUND SPA, UNLESS OTHERWISE SPECIFIED.
2. (2) SYMBOL SHOWS 8 OPTIONAL INTERIOR PERIMETER LIGHT LOCATIONS.
3. IF EQUIPPED, OZONATOR IS LOCATED BEHIND PANEL ON THE PUMP/PACK SIDE.
4. DRAIN VALVE LOCATED BEHIND PANEL ON THE PUMP/PACK SIDE
5. SEE OWNERS MANUAL FOR COMPLETE LOCATING , ELECTRICAL AND SAFETY INSTRUCTIONS.
6. LOAD: 160 PSF

*COVER LIFTER AND STEP ARE PART OF SUITE PACKAGE.

RECOMMENDED ELECTRICAL PASS-THROUGH AREA FOR PERMANENT WIRING OF CS3-PU2 OR CONVERTED CS3-PU1. SEE ROUTING & ELECTRICAL SUGGESTIONS.

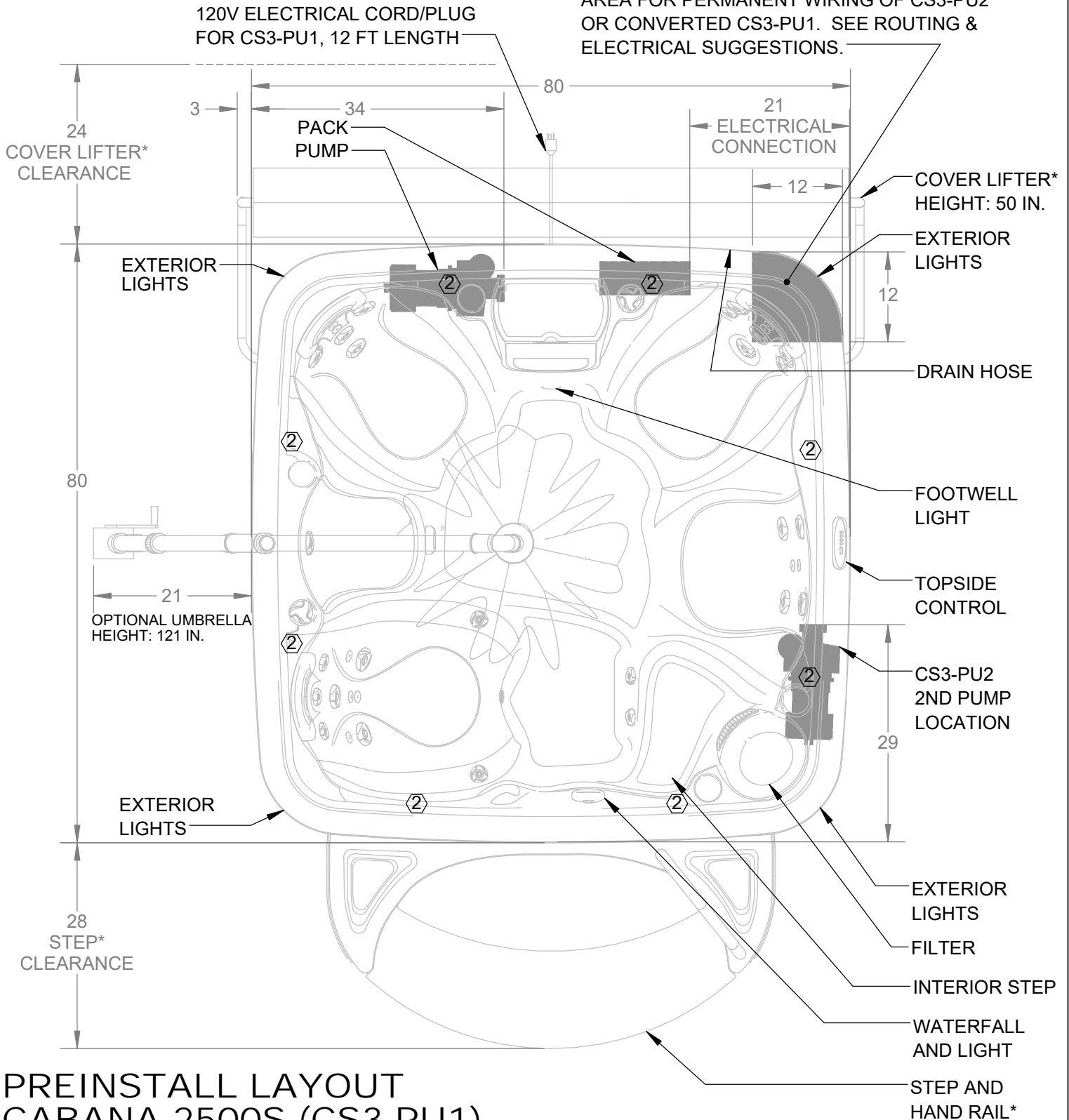

**PREINSTALL LAYOUT
CABANA 2500S (CS3-PU1)
CABANA 3500S (CS3-PU2)
SUITE PACKAGE**